



1/229 Loftus Avenue LOFTUS NSW

3 2 2

Boasting house-like proportions, this single-level brick residence offers the perfect opportunity for those looking for a low-maintenance lifestyle. Ready for immediate enjoyment and conveniently close to Loftus shops, schools and Loftus train station.

Price : \$ 1,070,000
Building Size : 499 sqm
View : <https://www.crippsandcripps.com.au/sale/nsw/sutherland/loftus/residential/villa/6838882>

Bright low maintenance residence set over a single level
Ideally positioned on a 499sqm lot. corner block
Spacious timber kitchen with breakfast bar
Three good-sized bedrooms, two with built-ins, main with ensuite and walk in robe
Family-sized bathroom
Walk in storage/linen press
Double side by side auto lock-up garage with drive through to a rear yard



Jason Hawes
02 9523 6511



Samantha Biddlecombe
02 9523 6511

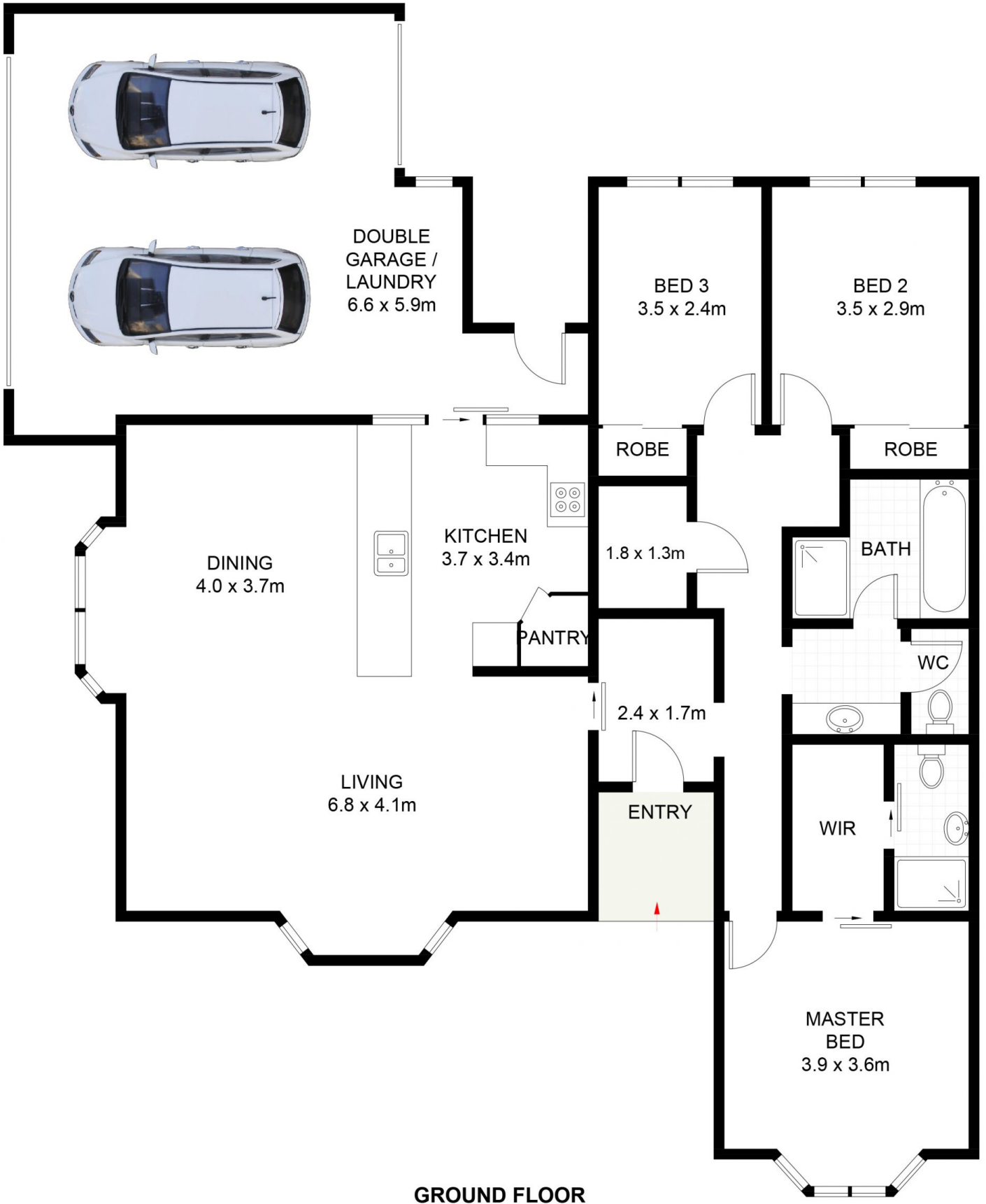

1/229 Loftus Avenue, Loftus

Scale in metres. Indicative only. Dimensions are approximate. All information contained herein is gathered from sources we believe to be reliable. However, we cannot guarantee its accuracy and interested persons should rely on their own enquiries. Some images may contain digital furniture.