



5e/5-29 Wandella Road MIRANDA NSW

2  1  1 

Offering an ultimate convenient lifestyle in a sought after location, this two-bedroom apartment is perfectly positioned in a well-maintained security complex and offers an ideal north-facing aspect. Situated only moments to shops, schools, and cafes, this is the perfect opportunity for those looking for an investment or first home.

Price : \$ 605,000
Building Size : 117 sqm
View : <https://www.crippsandcripps.com.au/sale/nsw/sutherland/miranda/residential/apartment/6232101>

East facing covered balcony overlooking Seymour Shaw Park
Well-equipped kitchen offering ample bench space
Two generous bedrooms, both with mirrored built-in wardrobes
Downlights and Floorboards throughout
Single lock up garage and storage cage in a secure basement
Indoor and outdoor pools plus sauna
Walking distance to Miranda Westfield & Miranda station



Jason Hawes
02 9523 6511



(NOT SHOWN IN ACTUAL LOCATION / ORIENTATION)

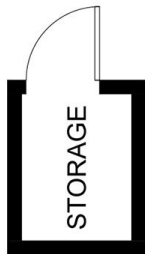

(NOT SHOWN IN ACTUAL LOCATION / ORIENTATION)



5E/5-29 Wandella Road, Miranda

Scale in metres. Indicative only. Dimensions are approximate. All information contained herein is gathered from sources we believe to be reliable. However, we cannot guarantee its accuracy and interested persons should rely on their own enquiries.