



Shop 3 62-64 Coachwood Crescent ALFORDS POINT NSW

- * 58SQM
- * BUSY VILLAGE SHOPPING COMPLEX
- * CORNER OF COACHWOOD CRESCENT & BRUSHWOOD DRIVE
- * CLOSE PROXIMITY TO ALFORDS POINT PRIMARY SCHOOL
- * CUSTOMER PARKING
- * AMONG OTHER ESTABLISHED BUSINESSES

Building Size : 58 sqm
View : <https://www.crippsandcripps.com.au/lease/nsw/sutherland/alfords-point/commercial/retail/5957189>



Tracey Metcalf
 02 9523 6511

STRATA PLAN

AREAS ARE APPROXIMATE.
⊕ CAR PARKING SPACE
○ COMMON PROPERTY

SCHEDULE OF UNIT ENTITLEMENTS

LOT N°	UNIT ENTITLEMENT
1	1
2	1
3	1
4	1
5	1
6	5
AGGREGATE	10

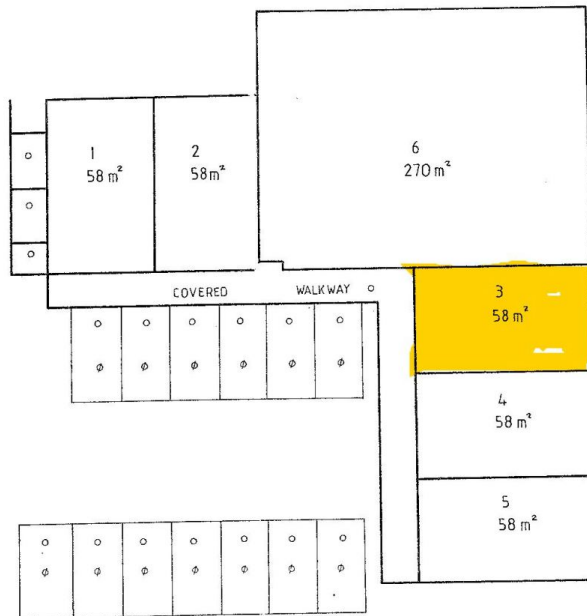

GROUND FLOOR

Reduction Ratio 1: 200

Lengths are in metres

Signature
Registered Surveyor

Council Clerk

SURVEYOR'S REFERENCE: 9010

