



59 Bellingara Road SYLVANIA NSW

3 1 5

This North East facing gem is positioned on a 658sqm block filled with limitless potential. The garage is a large tandem and has fantastic storage facilities, the home has dual access driveways.

Having an 18.30m frontage and an R2 zoning, this block has the option of being developed into a dual occupancy or a very large sized family dream home! The floorplan comprises of three bedrooms with built-ins, large study or fourth bedroom, one bathroom and a large kitchen into dining with air conditioning. With original floorboards throughout and a large backyard for the kids, this home presents a great opportunity for a family looking to live in the area for many years to come.

Price : \$ 1,380,000
Land Size : 658 sqm
View : <https://www.crippsandcripps.com.au/sale/nsw/sutherland/sylvania/residential/house/5957026>



Brett Cripps
 02 9523 6511

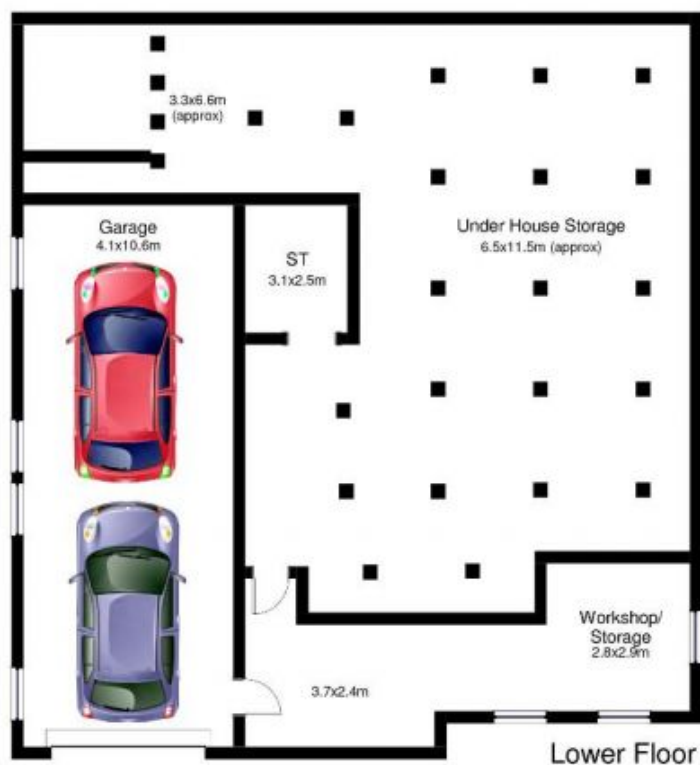

59 Bellingara Road, Sylvania

DISCLAIMER: This is for illustrative purposes only. All dimensions are approximate and it does not constitute part of any legal documents.