



30 Glaisher Parade CRONULLA NSW

4 1 1

This rare opportunity has not been offered to the market for over 45 years, its esplanade address overlooks the head of the Port Hacking river near Bass and Flinders Pt.

The house sits on 749sqm of land in the E4 Environmental Living zoning, the frontage is 15.24 mts and the house is either a renovators dream or a chance to build your dream home. Refer to Floorplan icon for Survey of property.

There will be no price guide given but comparable sales will be supplied at the open house, this property will be going to auction.

AUCTION 25TH FEBRUARY AT 4.45PM ON SITE
REGISTRATIONS FROM 4PM

Price : \$ 2,925,000
Land Size : 749 sqm
View : <https://www.crippsandcripps.com.au/sale/nsw/sutherland/cronulla/residential/house/5956969>



Brett Cripps
02 9523 6511

Survey 30 Glaisher Rd CRONULLA
18/8/71

GLAISHER PARADE

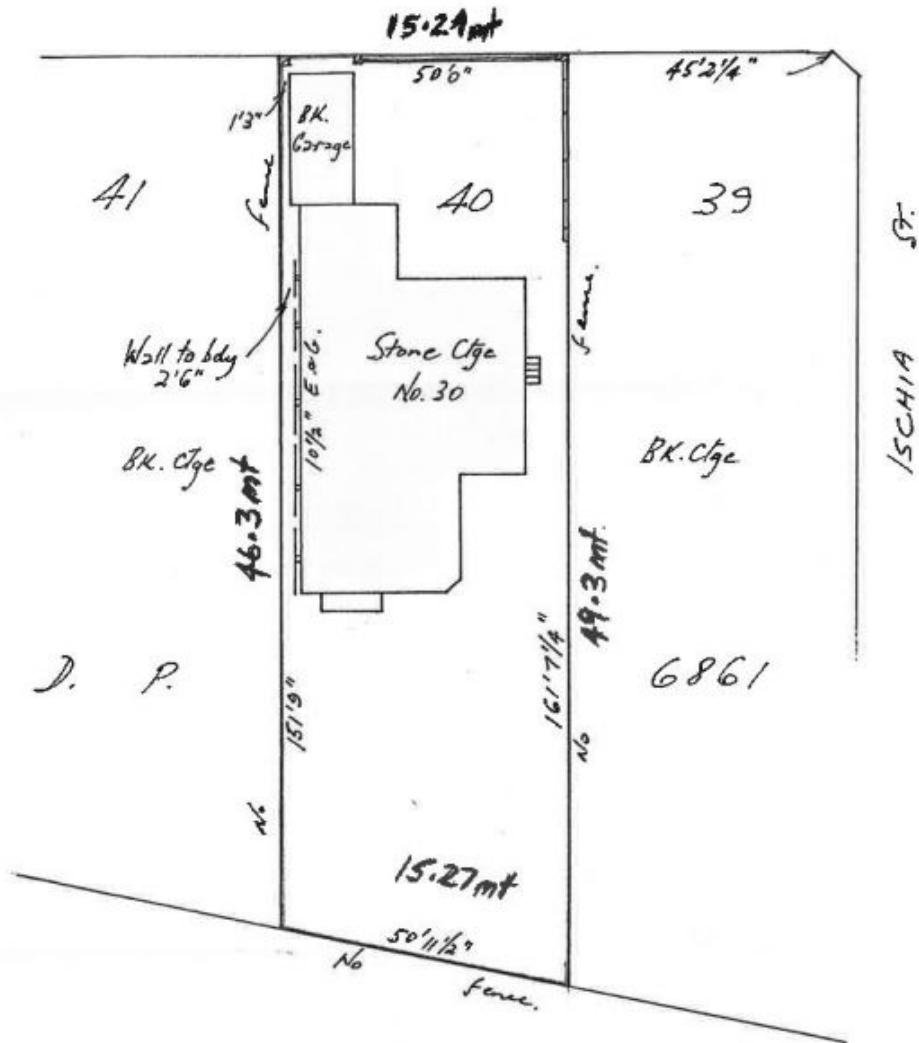

J. P.

6861