





22/77 Belmont Street SUTHERLAND NSW

3  2  2 

If your looking for the quiet life but only a stones throw away from Sutherland Central then come and inspect this fantastic Nth facing townhouse.

View : <https://www.crippsandcripps.com.au/sale/nsw/sutherland/sutherland/residential/townhouse/5956911>

Features include

freshly painted , new carpet, new floorboards
3 bedrooms all with built ins , main has ensuite
nice size north facing grassed courtyard
separate lounge and dining room
basement security car park, 2 spaces, 2 storage cages



Brett Cripps
02 9523 6511

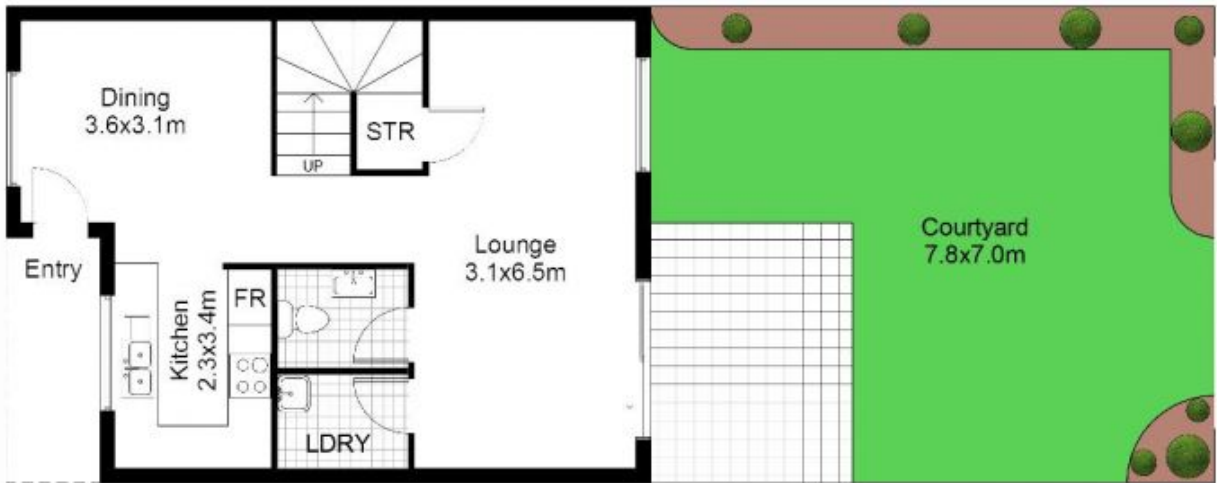
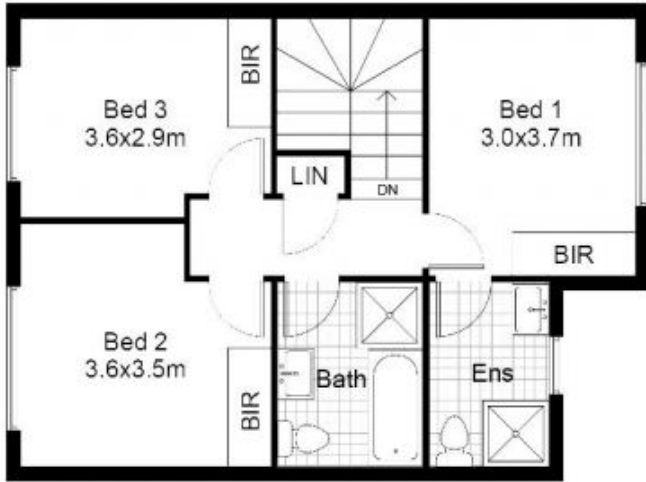

22/77-79 Belmont St, SUTHERLAND

DISCLAIMER: All care has been taken in preparing this floor plan, however the accuracy is not guaranteed
 and no liability will be accepted for any reliance placed upon it.
 Produced by PRODUCT PHOTOGRAPHY STUDIO mob: 0414 697 215 email: mgphoto@people.net.au