

18/25-29 Koorabel Avenue GYMEA NSW

2 1 2

This impressive over sized apartment is positioned within easy walking distance of Gymea Shopping Village and cafe strip, set on the top floor that enjoys distant views and lovely Nth East breezes this is an opportunity not to be missed, the property proudly ticks all of the boxes with features that include:

2 good sized bedrooms both with beautiful plantation shutters, main with a sunny second balcony

Updated kitchen with granite bench tops and new stainless steel appliances

Combined lounge and dining areas with new light fittings, Foxtel Ready

Light and bright bathroom, 2nd WC in laundry

Price : \$ 705,000
Building Size : 90 sqm
View : <https://www.crippsandcripps.com.au/sale/nsw/sutherland/gymea/residential/unit/5956870>



Jason Hawes
02 9523 6511

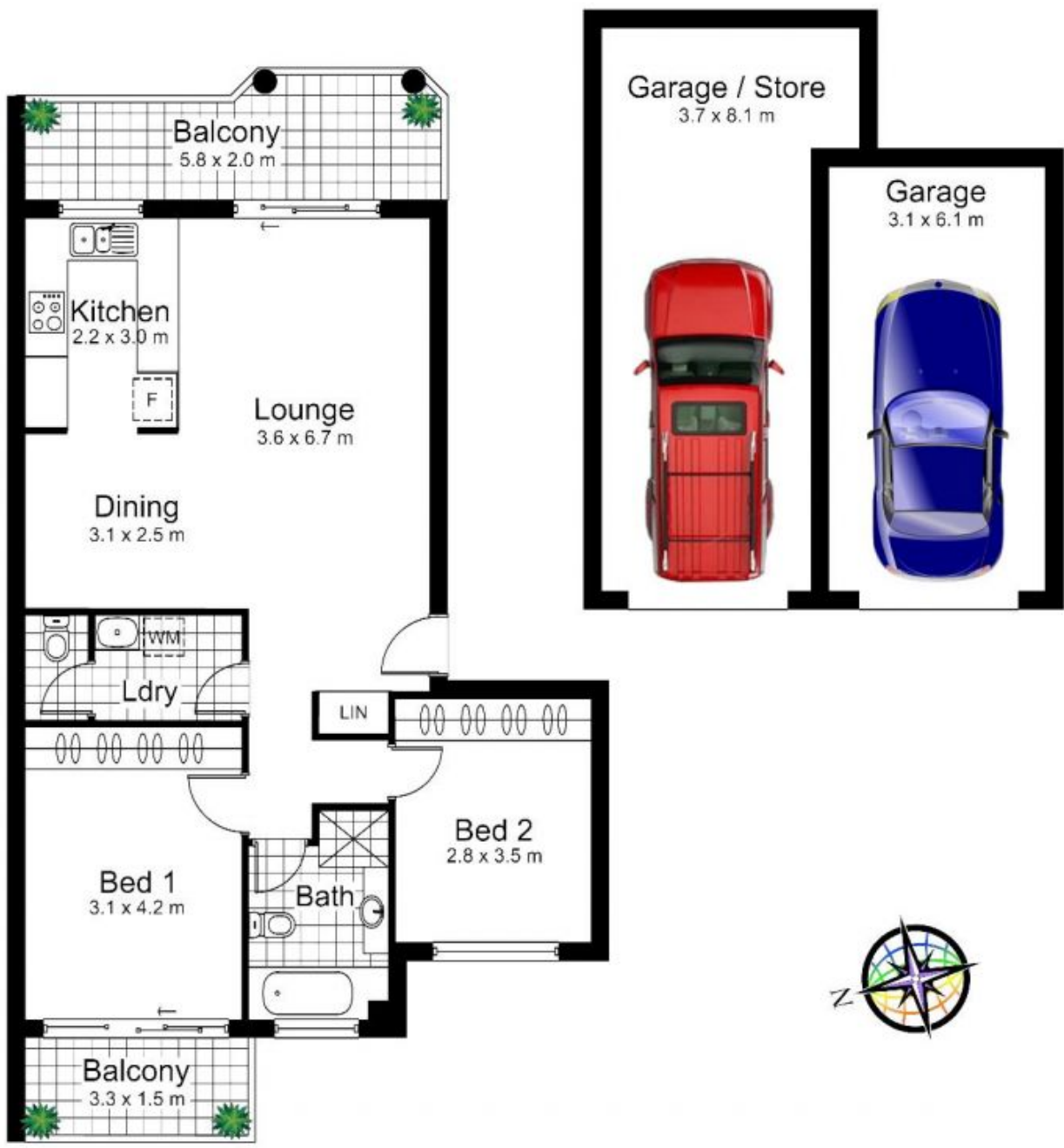

18 / 25-29 Koorabel Avenue, GYMEA

DISCLAIMER: All care has been taken in preparing this floor plan, however the accuracy is not guaranteed and no liability will be accepted for any reliance placed upon it
 Produced by PRODUCT PHOTOGRAPHY STUDIO mob: 0414 697 215 email: mgphoto@people.net.au