



24 Woodward Avenue CARINGBAH SOUTH NSW

3 2 2

Currently existing is an original 3 bedroom spacious family home with a huge double garage with excavated area adjoining. A fabulous home or investment opportunity to be redeveloped.

View : <https://www.crippsandcripps.com.au/sale/nsw/sutherland/caringbah-south/residential/house/5956819>

Builders and Developers please note this exciting opportunity arises rarely to acquire one of the most sought-after positions as a potential re development site.

Close proximity to transport and Caringbah Shopping Village. The perfect site to build a small complex to your architects design.

Land size approx. 670sqm (18.2m frontage x 34.75m depth)
LEP 2015 - Zone R2 FSR 0.55:1*



Jason Hawes
02 9523 6511

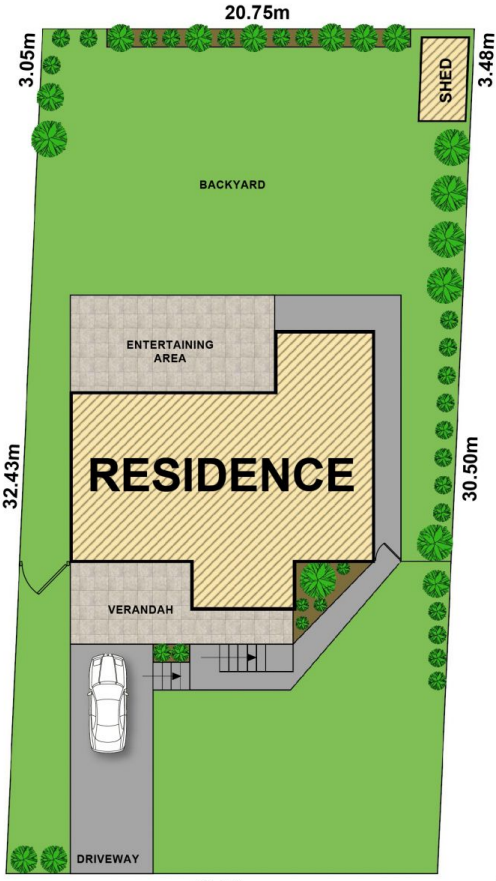

SITE PLAN (not to scale)

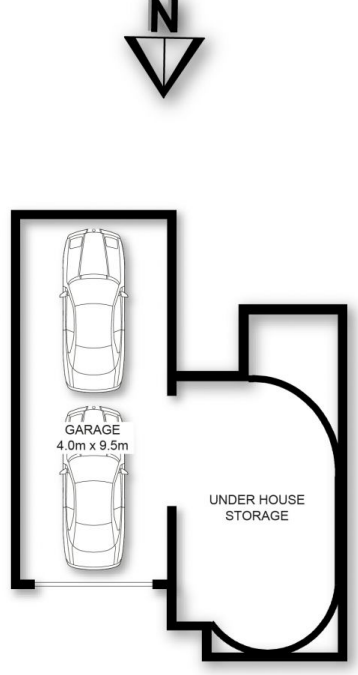

ADDRESS:

24 Woodward Avenue, CARINGBAH SOUTH



DISCLAIMER: THIS IS FOR ILLUSTRATIVE PURPOSES ONLY. ALL DIMENSIONS ARE APPROXIMATE AND IT DOES NOT CONSTITUTE PART OF ANY LEGAL DOCUMENTS.