



53 Hotham Road GYMEA NSW

4 3 1

If you are looking for space to accommodate a growing family and want value for your money, then this is the perfect place to call home.

Featuring light filled interiors throughout, this generously proportioned home boasts a choice of formal and casual areas that naturally integrate with the outdoors perfect for BBQ's and entertaining your friends. Safe, secure and fully fenced pool area all within eyesight of the main living and outdoor entertaining makes an easy everyday lifestyle all within reach.

It combines flowing living spaces, a versatile layout and a wonderful environment for kids and teens of all ages.

Added Bonus - also includes a separate self-contained studio with its own external access - offers the perfect

Price : \$ 1,100,000

View : <https://www.crippsandcripps.com.au/sale/nsw/sutherland/gyMEA/residential/house/5956799>



Jenny Duff
02 9523 6511

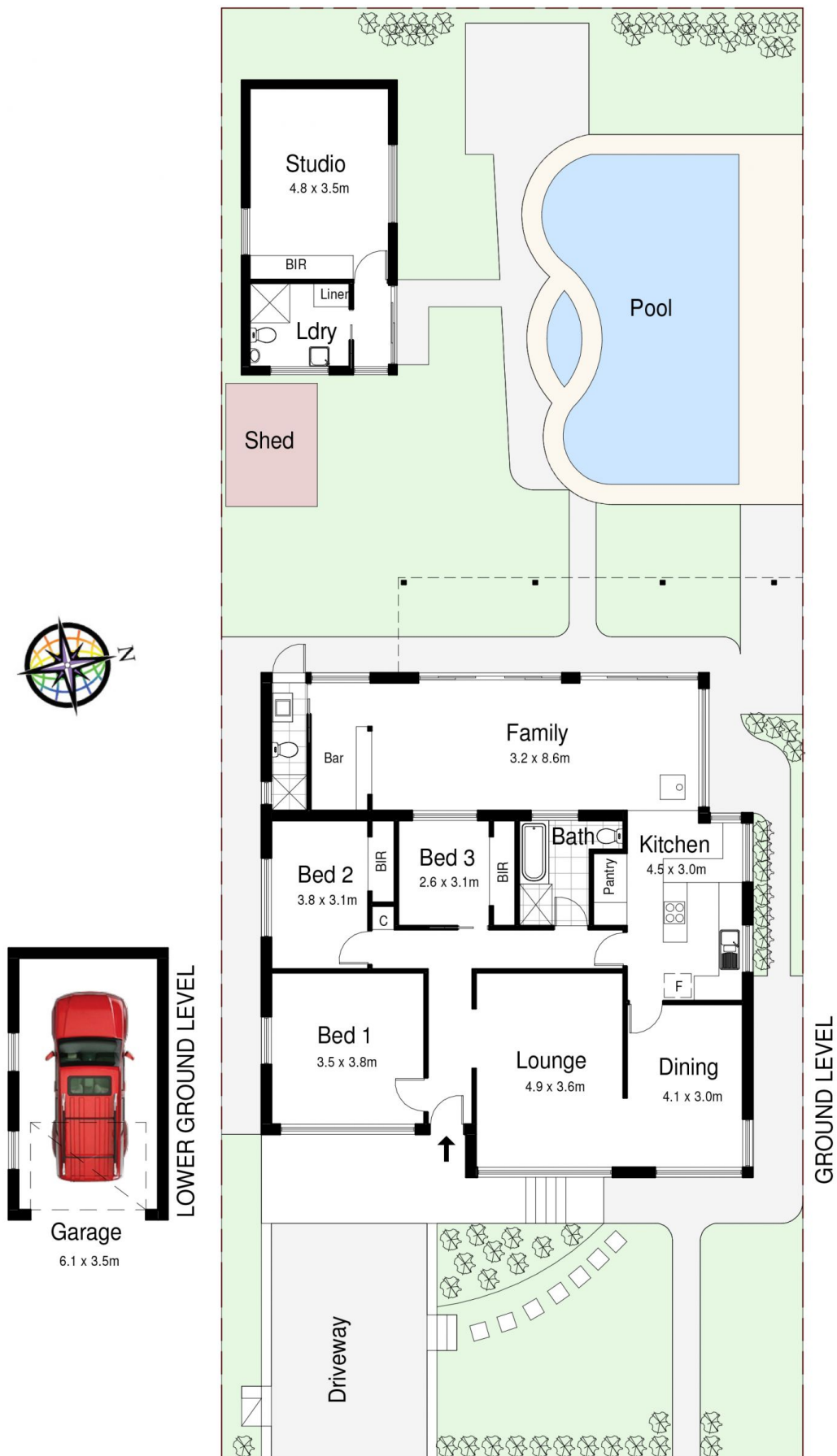

53 Hotham Road, GYMEA

DISCLAIMER: All care has been taken in preparing this floorplan, however the accuracy is not guaranteed and no liability will be accepted for any reliance placed upon it
Produced by PRODUCT PHOTOGRAPHY STUDIO mob: 0414 697 215 email: mgphoto@people.net.au