



## 1/138 Gymea Bay Road GYMEA NSW

3 2 2

Set in an ultra convenient position close to all that Gymea Village has to offer this is an opportunity not to be missed with many quality features that include:

- 3 bedrooms, all with built in robes, Main with ensuite
- Brand new paint and carpet throughout
- Modern open plan kitchen that flows out to the living area
- Air conditioner and dishwasher
- Double side by side lock up garage, Internal laundry
- 3 separate wc's

The property would suit a variety of buyers including family buyers with plenty safe and secure yard to play in.

**Price** : \$ 758,000  
**Land Size** : 238 sqm  
**View** : <https://www.crippsandcripps.com.au/sale/nsw/sutherland/gymea/residential/townhouse/5954241>



**Jason Hawes**  
**02 9523 6511**

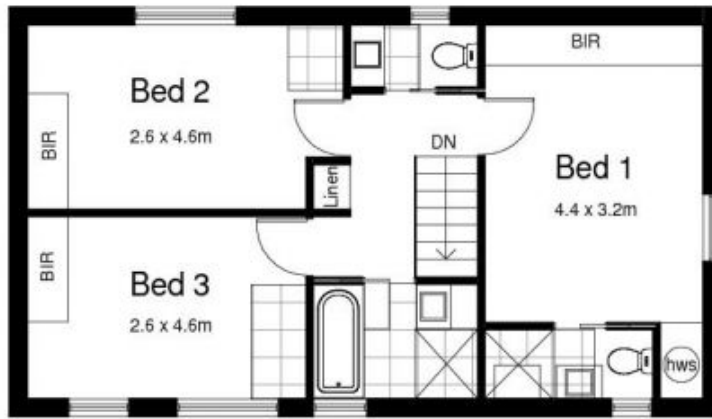

UPPER LEVEL



GROUND LEVEL

**1/138 GyMEA Bay Road, GYMEA**

DISCLAIMER: All care has been taken in preparing this floorplan, however the accuracy is not guaranteed and no liability will be accepted for any reliance placed upon it  
 Produced by PRODUCT PHOTOGRAPHY STUDIO mob: 0414 697 215 email: mgphoto@people.net.au