



18/25-29 Koorabel Avenue GYMEA NSW

2 1 2

Centrally located and enjoying an East West aspect, this light and bright top floor apartment is easily accessible to many of the area's lifestyle amenities. The property has many quality features that include:

- 2 bedrooms with built in robes, main with 2nd balcony
- Separate lounge/ dining areas
- Internal laundry with 2nd WC
- Main balcony off the living area with distant views over Gymea and beyond
- Security access & Foxtel ready

This fantastic property is ideally suited to discerning first home buyers or investors.

Strata: \$553.60 p/q  
Water: \$144.10 p/q

**Building Size** : 90 sqm  
**View** : <https://www.crippsandcripps.com.au/sale/nsw/sutherland/gymea/residential/apartment/5954020>



**Jason Hawes**  
02 9523 6511

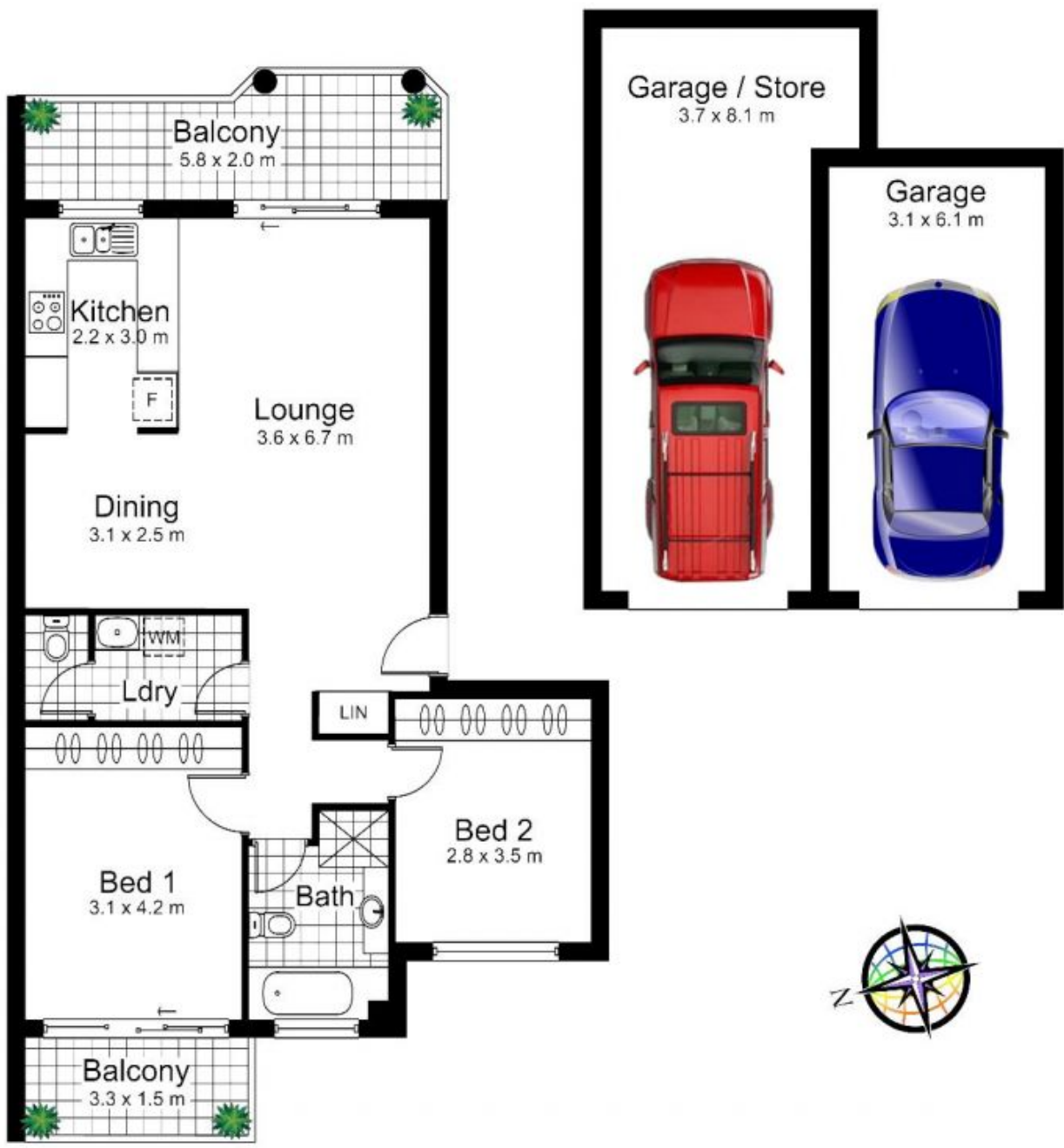

## 18 / 25-29 Koorabel Avenue, GYMEA

DISCLAIMER: All care has been taken in preparing this floor plan, however the accuracy is not guaranteed and no liability will be accepted for any reliance placed upon it  
 Produced by PRODUCT PHOTOGRAPHY STUDIO mob: 0414 697 215 email: mgphoto@people.net.au